

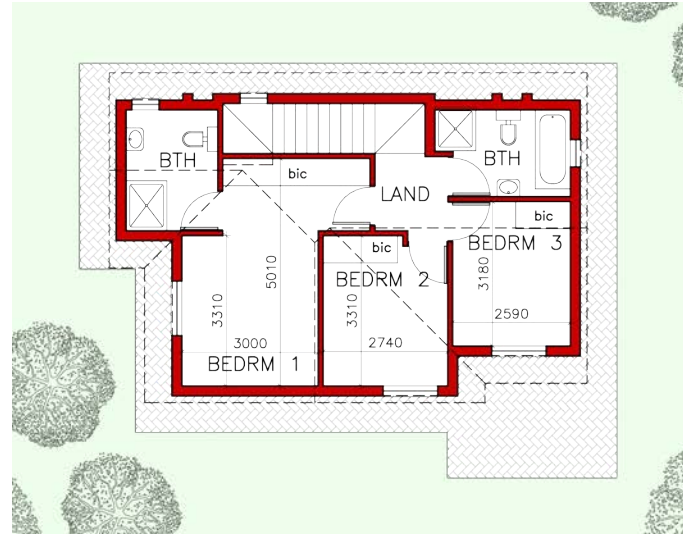

FIRST FLOOR ROOM LAYOUT



FIRST FLOOR PLAN



GROUND FLOOR ROOM LAYOUT



GROUND FLOOR PLAN

***PLEASE NOTE**
 -ARTIST IMPRESSIONS ONLY
 -CHOOSE ALL COLOURS FROM COLOUR RANGE SPECIFICATION
 -ANY COLOUR SHOWN IS INDICATIVE ONLY
 -NO FURNITURE INCLUDED



PERSPECTIVE



**HOMES
FOR ALL**

PRESIDENT PARK EXT. 70

PRP 115

115 SQUARE METERS

GROUND FLOOR :	60.47m ²
FIRST FLOOR :	54.54m ²
OPEN STOEP :	9.00m ²
TOTAL :	115.01m ²

STAND NR: _____

CLIENT: _____

SIGNATURE: _____

DATE: _____



ARCHITECTURAL & PROJECT SERVICES